

Return Duct Kit

Part No. 4035646

Parts Included:



Tools Required: Torx T20 Screwdriver

⚠ CAUTION! Before installing duct kit, disconnect dehumidifier from electrical power and disconnect duct work if previously installed.

Step 1: Remove six screws (three on each side) from the Advance2 dehumidifier.

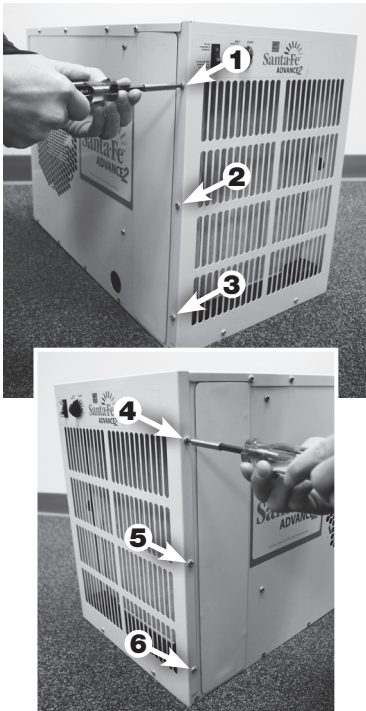

Step 2: Place duct kit assembly on dehumidifier and line up holes on assembly with screw holes.

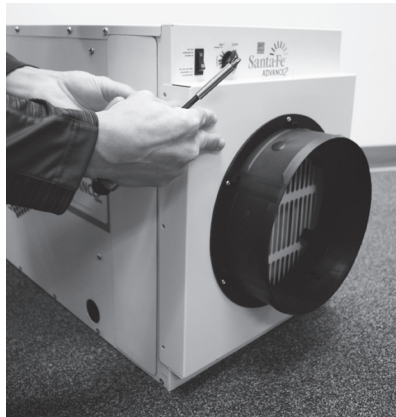

Step 3: Using six screws previously removed, replace screws into holes to secure duct kit assembly.

